

Ascend Six Screen with Lateral Extension Plates and Desk Clamp

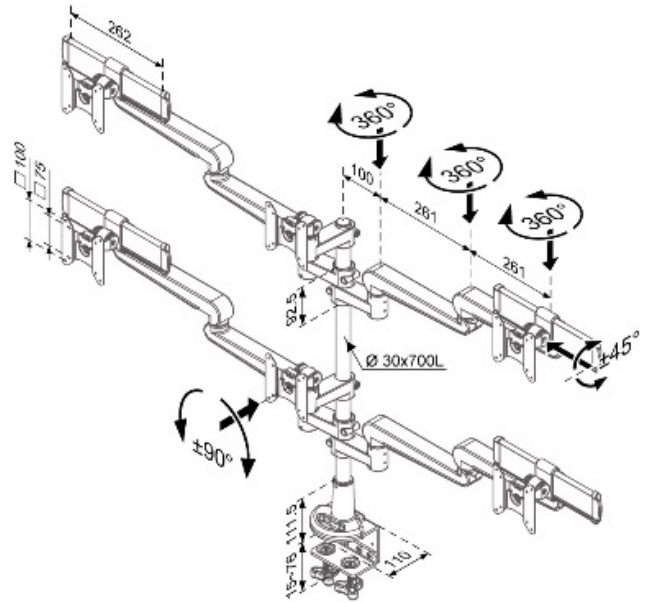

Clamp Type
unit:mm

Product Specification

Product code	CMS2981W (White)
Weight capacity	Each arm holds screens up to 6kg each
Height adjustment range	600mm at full extension (single extending arm length)
Screen size	Screen sizes up to 32" *
RAL codes	RAL9006 (Silver) RAL9016 (White) RAL9017 (Black)
Movement	Height adjustment, tilt, swivel, rotation and reach

* Depending on model, check measurements

Additional Information

Customisable clamp depth dependent on requirement

Integral cable management

Comes ready assembled for quick and easy installation

Over 90% of the Aluminium Alloy content is recycled



Ergo
01235 773373
www.ergo ltd.co.uk
sales@ergo ltd.co.uk